

ADVER-FLAG

FEATHER AND TEARDROP **GROUND STAND** ASSEMBLY INSTRUCTIONS



MADE IN CANADA

PARTS

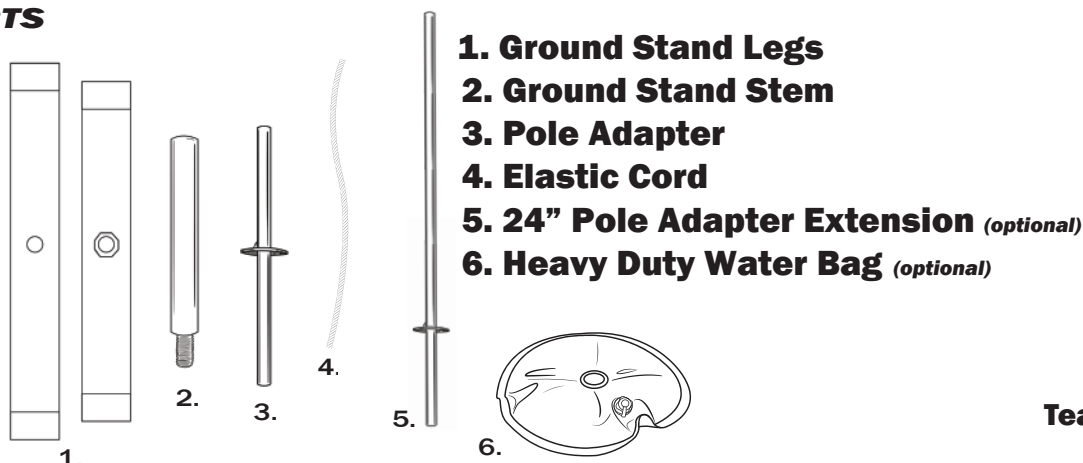

ASSEMBLY

1. Stack poles together to assemble (DO NOT TELESCOPE POLE). Once assembled, pull flag over pole.

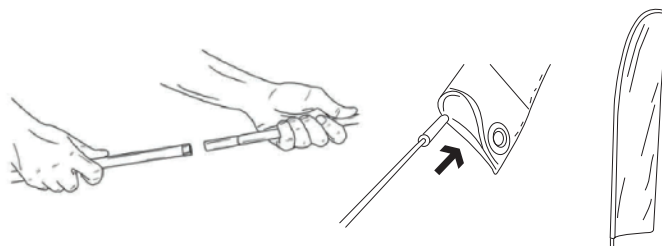

2. Take the cord and fold it in half, looping it through the grommet and threading the rest of the cord through the loop.

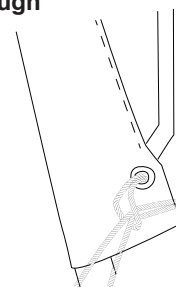

3. Pull flag and cord down until snug on pole. Once placement is decided, pull cord down toward the anchors, and wrap tightly under both anchors until secure.

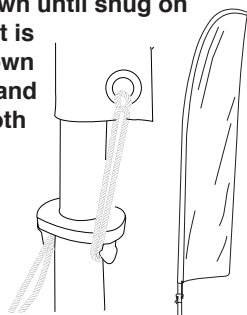

4. Next, setup the ground stand system by placing the legs across one another with the nut of the leg facing the ground.

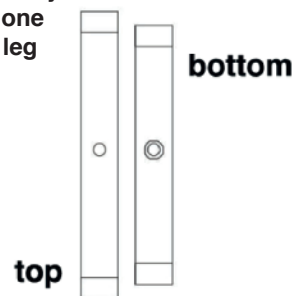
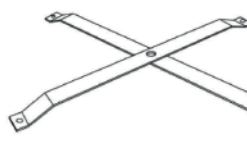

5. With the nut on the bottom of the stand, screw the Ground Stand Stem into place securing both legs together in an "X" position.

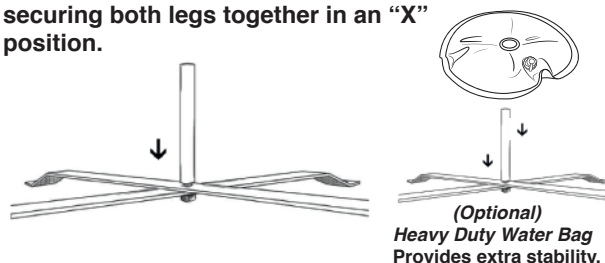

6. Place the Pole Adapter into the Ground Stand Stem, and then place the flag onto the Pole Adapter. Note: If using the 24" Pole Adapter Extension, insert it into Ground Stand Stem, then place the Pole Adapter and flag atop of the Extension.

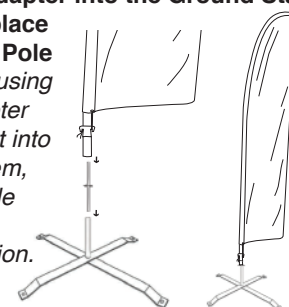

! GUIDES AND PRECAUTIONS !

- Flag system may be damaged in winds exceeding 35 km/hr.
PLEASE DO NOT USE IN INCLEMENT WEATHER.

- Do not use near overhead wires, if not used correctly it may result in injury or death.

- Must have rotational movement. Keep at least 5ft away from any objects to increase life expectancy of flags. IE Fences, Trees, Buildings Etc.